



# 670

**Router made of solid carbide with diamond-patterned teeth (high performance geometry).**

**Applications/Advantages:**

- outer contour
- all kind of glass-epoxy based materials
- long life time and excellent performance

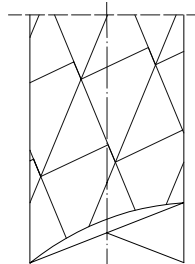
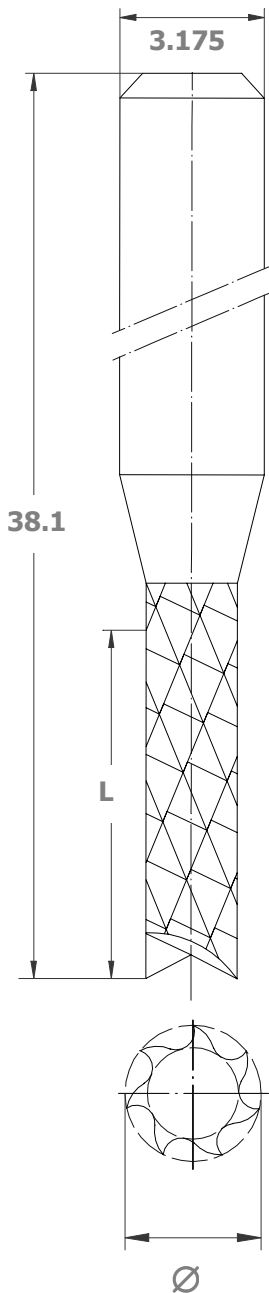

fishtail cut

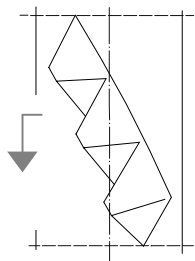

down cut  
(left twisted)

Ø [mm]	L [mm]
	9.0
1.6	x
2.0	x
2.4	x

Routing parameters (stack of 4 x 1.6 mm)

Ø [mm]	spindle speed [RPM]	XY-routing feed [m/min]	for ball bearing spindle [m/min]
1.6	48 000 - 55 000	1.0	1.0
2.0	42 000 - 45 000	1.5	1.8
2.4	35 000 - 38 000	1.6	2.0